

### To Insert Strap:

Press button on side of glasses to release arms. Insert strap into opening and "click" into place

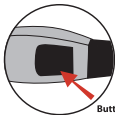

### To Remove Strap:

Press on the same button to release the strap, then replace the sunglass arms.

## Inserting or Removing Foam Eye Pad:

1

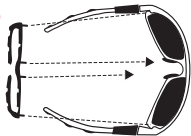

Align the foam + frame nose piece by squeezing in the sides of the foam.

2

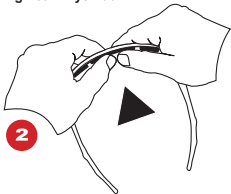

Align the nose piece of frame with the nose piece of foam.

3



Press the 2 tabs on the foam into the holes near the temples. The insert will fit securely into place.